

— PLAQUE DE FIXATION DU CAPOT — 16

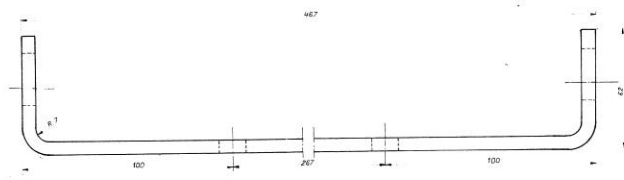

— CHARNIÈRE DU CAPOT — 16 bis

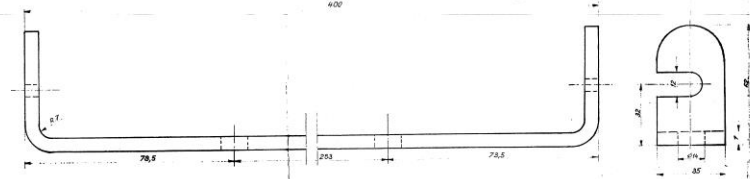

— CAPOT — 18

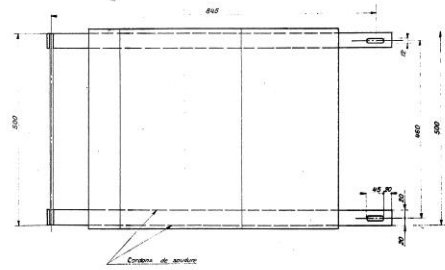
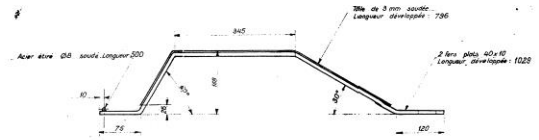

CROCHET DE FIXATION DU CAPOT 17

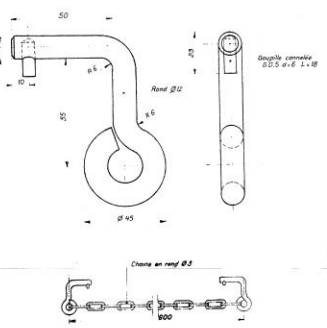

Développement du support

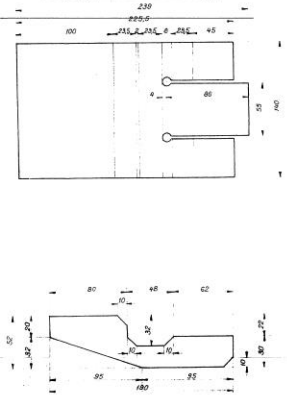

— SUPPORT DE COMMUTATEUR — 21

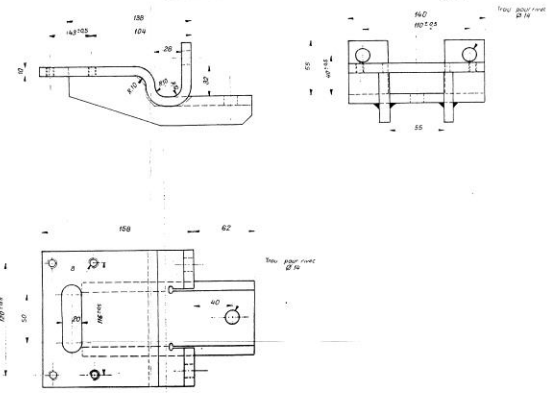

— PLAQUETTE ISOLANTE — 30

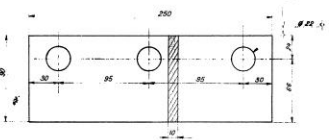

— PLAQUETTE DE CALAGE — 36

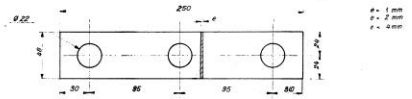

— PLAQUE D'EXTREMITE — 31

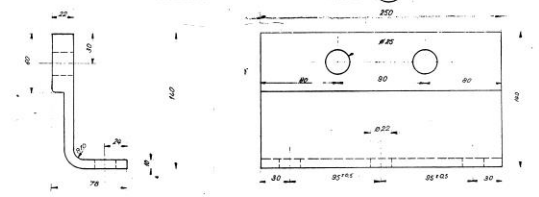

— CALE DE RÉGLAGE — 33

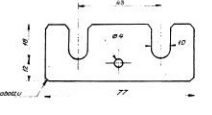

— RONDELLE PLATE — 27

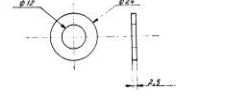

— GOUJON — 22



— GOUJON — 23

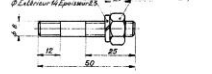

— BAGUE ISOLANTE — 29



— RONDELLE ISOLANTE — 28

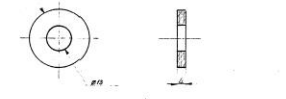

— BOULON — 26

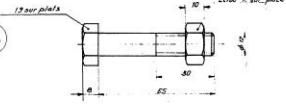

MÉTRO DE MEXICO			
VERROU AXIAL		DATE: 4 Sep 1967	
DÉTAILS		DESS: Lagouque	
		VEN: J. B. G.	
		L'Ingénieur en Chef	
		Chef de Service	
		I.S.T.M.E.	
		S.O.F.R.E.T.U. S.G.T.E.	
MODIFICATIONS		TV 194	